

**ACER**

Technology • Creativity • Reliability  
An Unswerving Commitment to Excellence

# ACER MACHINING CENTER



**VMC-2240 XL**

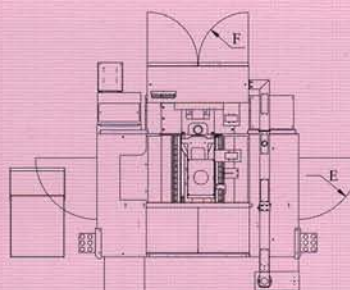
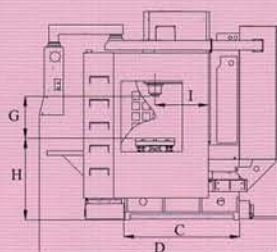
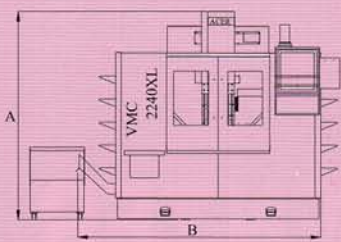

A	109.25"	2775mm
B	125.19"	3180mm
C	66.14"	1680mm
D	104.25"	2648mm
E	27.44"	R 697mm
F	19.62"	R 498.5mm
G	29.29"	744mm
H	33.46"	850mm
I	28.62"	727mm

## SPECIFICATIONS

MODEL	VMC-2240XL
<b>Table</b>	
Table size	43.3" x 22"
T-slots (No, wid, x dis)	3.93" x 0.7" x 0.2"
Table load	2,200 lb
<b>Travel</b>	
X travel	40.16"
Y travel	55"
Z travel	23.62"
<b>Spindle</b>	
Spindle nose to table	6"~29.6"
Spindle center to column	24.6"
Spindle taper	CAT40 / BT40
Spindle speed (RPM)	8,000 (Std.) 12,000 (Optional)
<b>Feedrates</b>	
Rapid on (X / Y / Z)	950 / 950 / 787 in/min 1,417 / 1,417 / 950 in/min
Cutting feedrate	400 in/min
<b>Accuracy</b>	
Positioning	±0.0002"
Repeatability	±0.00012"
<b>Tool changer</b>	
Tool capacity	Arm type 24T (2.1 sec)
Max. tool diameter	4.75"
Max. tool weight (each)	13.2 lb
<b>Motor</b>	
Spindle motor (AC digital)	10 HP / 15 HP (30 min peak)
Drive motor X, Y, Z (AC digital)	2 HP x 2 HP x 2.75 HP
Coolant motor	1 HP
<b>General</b>	
Power required (approx.)	100 AMP
Air required	96 PSI
Floor space (L x W x H)	150" x 111" x 102"
Min. operation space (package)	119" x 89" x 102"
Net weight (approx.)	13,860 lb
Gross weight (approx.)	14,740 lb

## STANDARD ACCESSORIES

- 24 station ATC (arm type)
- Rigid tapping
- Coolant pump and nozzles
- Halogen light
- Electrical maintenance manual
- Operation manual & parts list
- Leveling pads & bolts
- Tool box with tool
- 15 KVA transformer
- X, Y, Z axis telescopic steel way cover
- FANUC series *oi*-MC or Anilam 6,300 M control
- Full enclosure splash guard
- Lubrication system
- Three axes linear guide way
- Floating air tool change
- Open door power disconnect
- Tool holder rack-60 pcs

Note: The manufacture reserves the right to modify the design, specifications, mechanisms, etc. to improve the performances of machine without notice.  
All the specifications shown above are for reference only.

Web site: <http://www.acergroup.com>

Factory E-mail Address: [acergroup@msa.hinet.net](mailto:acergroup@msa.hinet.net)

**SPRINGWOOD INDUSTRIAL, INC.**

1062 N. Kraemer Place

Anaheim, CA 92806

Tel: (714) 632-9701

Fax: (714) 632-9730

**KLIM INDUSTRIAL, INC.**

244 N. Randolphville Rd.

Piscataway, NJ 08854

Tel: (732) 752-9100

Fax: (732) 752-9101

LA E-mail Add: [info@acergroup.com](mailto:info@acergroup.com)

NJ E-mail Add: [acer\\_klim@yahoo.com](mailto:acer_klim@yahoo.com)

**TAIWAN SPRINGWOOD INTERNATIONAL, INC.**

No.101, 506 Lane, Seng Tso Rd.

Seng Karng Shang, Taichung County, Taiwan

Tel: 011886-4-2520-4120 Fax: 011886-4-2520-4123

Cat VMC-2240 0703x2000