

# **M. COMPLETE KNOCKDOWN DRAWINGS & PARTS LISTS**

**WHEN ORDERING PARTS, PLEASE MENTION:**

- 1. MACHINE MODEL & SERIAL NUMBER.**
- 2. ITEM NUMBER.**
- 3. PART NUMBER AND NAME.**
- 4. YEAR OF PRODUCTION.**
- 5. QUANTITY**

# 2040&2060 AHD CONTROL PANEL

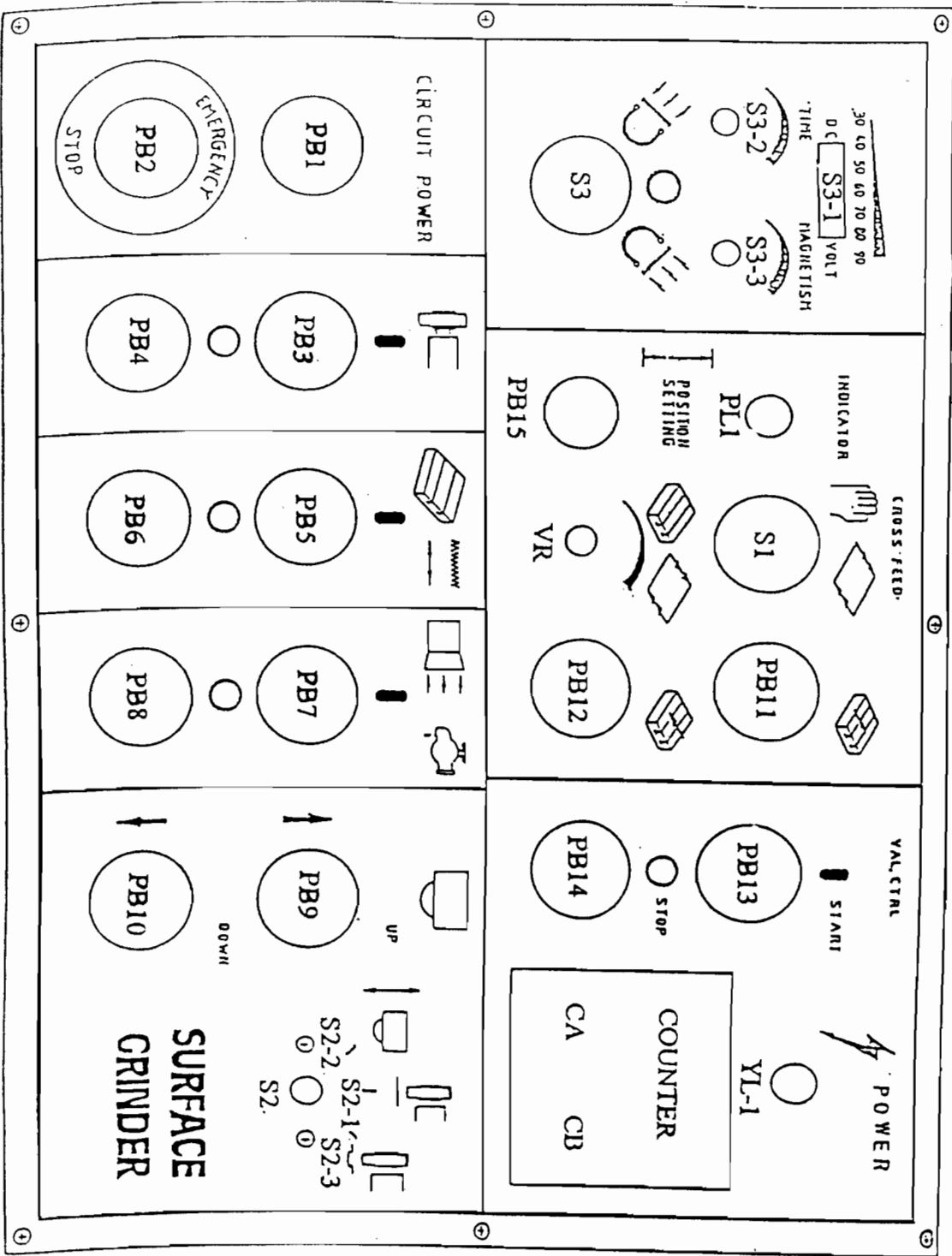

# 2040&2060 AH CONTROL PANEL

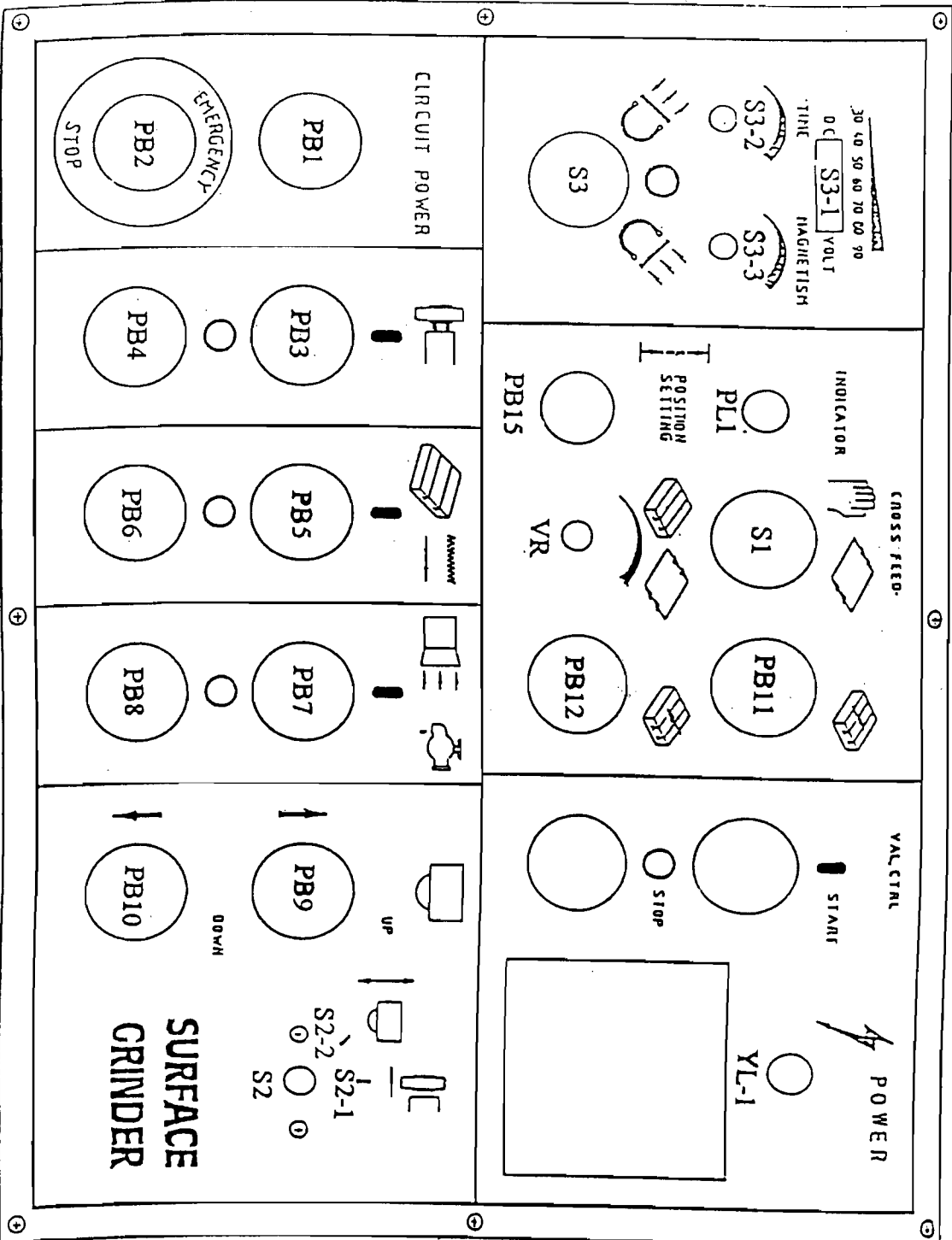

2040&2060 AHD CONTROL PANEL & ELECTRIC PARTS DESCRIPTION

YL1	INDICATE LAMP OF POWER SOURCE.
PB1	PUSH BUTTON "ON" OF CONTROL CIRCUIT SOURCE WITH INDICATE LAMP.
PB2	PUSH BUTTON "OFF" OF CONTROL CIRCUIT SOURCE.
PB3	PUSH BUTTON "ON" OF SPINDLE MOTOR WITH INDICATE LAMP.
PB4	PUSH BUTTON "OFF" OF SPINDLE MOTOR.
PB5	PUSH BUTTON "ON" OF HYDRAULIC PUMP WITH INDICATE LAMP.
PB6	PUSH BUTTON "OFF" OF HYDRAULIC PUMP.
PB7	PUSH BUTTON "ON" OF COOLANT OR DUST-SUCTION WITH INDICATE LAMP.
PB8	PUSH BUTTON "OFF" OF COOLANT OR DUST-SUCTION .
PB9	PUSH BUTTON FOR SPINDLE HEAD RAPID UPWARD. (ONLY S2 SWITCH CHOOSE ON: MODE IS WORKABLE)
PB10	PUSH BUTTON FOR SPINDLE HEAD RAPID DOWNWARD.(ONLY S2 SWITCH CHOOSE ON MODE IS WORKABLE)
PB11	PUSH BUTTON FOR SPINDLE SEAT FORWARD.
PB12	PUSH BUTTON FOR SPINDLE SEAT BACKWARD.
PB13	PUSH BUTTON"ON" FOR AUTO DOWNFEEED CIRCLE &HYDRAULIC VALVE& COUNTER.WITH INDICATE LAMP.
PB14	PUSH BUTTON"OFF" FOR AUTO DOWNFEEED CIRCLE &HYDRAULIC VALVE& COUNTER.WITH INDICATE LAMP.
PB15	PUSH BUTTON"OFF" FOR AUTO CROSS-FEED STORKE SETTING.
PL1	INDICATOR OF AUTO CROSS-FEED STORKE SETTING CONDITION.
COUNTER	COUNTER.(CA:FEED TIMES SETTING. CB:SPARK OUT TIMES SETTING.)
S1	MULTI-SELECT SWITCH OF OPERATION MODE.
VR	VARIABLE SPEED OF AUTO CROSS-FEED.
S2	SELECT SWITCH OF RAPID UP&DOWN OR SURFACE GRIND OR PLUNGE MODE.
S2-1	SURFACE GRINDING MODE.
S2-2	SPINDLE HEAD RAPID UP&DOWN MODE.
S2-3	PLUNGE MODE.
S3	SELECT SWITCH FOR CHUCK MAGNETIC OR DEMAGNETIC CONTROL.
S3-1	INDICATE LED OF STRENGTH OF MAGNETISM.
S3-2	VARIABLE RESISTANCE FOR DEMAGNETIZE TIME ADJUSTING.
S3-3	VARIABLE RESISTANCE FOR STRENGTH OF MAGNETISM ADJUSTING.
MS0	MAGNETIC CONTACTOR OF CIRCUIT CONTROL SOURCE.
MS1	MAGNETIC CONTACTOR OF HYDRAULIC PUMP MOTOR.
MS2	MAGNETIC CONTACTOR OF SPINDLE MOTOR.
MS3 MS4	MAGNETIC CONTACTOR OF SPINDLE SEAT CROSS-FEED MOTOR.
MS5	MAGNETIC CONTACTOR OF COOLANT OR DUST-SUCTION MOTOR.
MS6 MS7	MAGNETIC CONTACTOR OF SPINDLE SEAT UP&DOWN MOTOR.
M1	HYDRAULIC PUMP MOTOR.
M2	SPINDLE MOTOR.
M3	SPINDLE SEAT FORWARD&BACKWARD CONTROL MOTOR.
M4	COOLANT&DUST-SUCTION MOTOR.
M5	SPINDLE SEAT UP&DOWN MOTOR.
LS1	APPROXIMATE SWITCH FOR AUTO CROSS-FEED TRIGGER SIGNAL.
PXS1 PXS2	APPROXIMATE SWITCH FOR SETTING STROKE OF AUTO CROSS-FEED.
LS4 LS5	LIMIT SWITCH FOR MAX. TRAVEL OF SPINDLE SEAT.
OL1,OL2 OL3,OL4 OL5,OL6	CURRENT OVERLOAD.
1PH tr.	1 PHASE TR.(FOR CONTROL CIRCUIT &EM.CHUCK POWER SUPPLY).
3PH tr.	3 PHASE TR.(FOR SPINDLE SEAT RAPID UP&DOWN AND CROSS-FEED,LUBRICANT PUMP,PAPER FILTER MOTOR).

# 2040&2060 AH CONTROL PANEL & ELECTRIC PARTS DESCRIPTION

YL1	INDICATE LAMP OF POWER SOURCE.
PB1	PUSH BUTTON "ON" OF CONTROL CIRCUIT SOURCE WITH INDICATE LAMP.
PB2	PUSH BUTTON "OFF" OF CONTROL CIRCUIT SOURCE.
PB3	PUSH BUTTON "ON" OF SPINDLE MOTOR WITH INDICATE LAMP.
PB4	PUSH BUTTON "OFF" OF SPINDLE MOTOR.
PB5	PUSH BUTTON "ON" OF HYDRAULIC PUMP WITH INDICATE LAMP.
PB6	PUSH BUTTON "OFF" OF HYDRAULIC PUMP.
PB7	PUSH BUTTON "ON" OF COOLANT OR DUST-SUCTION WITH INDICATE LAMP.
PB8	PUSH BUTTON "OFF" OF COOLANT OR DUST-SUCTION .
PB9	PUSH BUTTON FOR SPINDLE HEAD RAPID UPWARD. (ONLY S3 SWITCH CHOOSE ON MODE IS WORKABLE)
PB10	PUSH BUTTON FOR SPINDLE HEAD RAPID DOWNWARD.(ONLY S3 SWITCH CHOOSE ON MODE IS WORKABLE)
PB11	PUSH BUTTON FOR SPINDLE SEAT FORWARD.
PB12	PUSH BUTTON FOR SPINDLE SEAT BACKWARD.
PB15	PUSH BUTTON FOR SETTING POSITION OF AUTO CROSS-FEED CIRCLE.
PL1	AUTO CROSS-FEED STORK SETTING INDICATOR.
S1	MULTI-SELECT SWITCH OF OPERATION MODE.
VR	VARIABLE SPEED OF AUTO CROSS-FEED.
S2	SELECT SWITCH OF RAPID UP&DOWN OR SURFACE GRIND OR PLUNGE MODE.
S2-1	SURFACE GRINDING MODE.
S2-2	SPINDLE HEAD RAPID UP&DOWN MODE.
S2-3	PLUNGE MODE.
S3	SELECT SWITCH FOR CHUCK MAGNETIC OR DEMAGNETIC CONTROL.
S3-1	INDICATE LED OF STRENGTH OF MAGNETISM.
S3-2	VARIABLE RESISTANCE FOR DEMAGNETIZE TIME ADJUSTING.
S3-3	VARIABLE RESISTANCE FOR STRENGTH OF MAGNETISM ADJUSTING.
MS0	MAGNETIC CONTACTOR OF CIRCUIT CONTROL SOURCE.
MS1	MAGNETIC CONTACTOR OF HYDRAULIC PUMP MOTOR.
MS2	MAGNETIC CONTACTOR OF SPINDLE MOTOR.
MS3 MS4	MAGNETIC CONTACTOR OF SPINDLE SEAT CROSS-FEED MOTOR.
MS5	MAGNETIC CONTACTOR OF COOLANT OR DUST-SUCTION MOTOR.
MS6	MAGNETIC CONTACTOR OF LUBRICANT PUMP OF BASE SLIDE.
MS7 MS8	MAGNETIC CONTACTOR OF SPINDLE HEAD RAPID UP&DOWN .
M1	HYDRAULIC PUMP MOTOR.
M2	SPINDLE MOTOR.
M3	SPINDLE SEAT FORWARD&BACKWARD CONTROL MOTOR.
M4	SPINDLE HEAD RAPID UP&DOWN CONTROL MOTOR.
M5	COOLANT OR DUST-SUCTION MOTOR.
M6	LUBRICANT PUMP MOTOR OF BASE SLIDES .
LS1	APPROXIMATE SWITCH FOR AUTO CROSS-FEED TRIGGER SIGNAL .
PXS1 PXS2	APPROXIMATE SWITCH FOR SETTING STROKE OF AUTO CROSS-FEED.
LS4 LS5	LIMIT SWITCH FOR MAX.TRAVEL OF SPINDLE SEAT.
OL1,OL2 OL3,OL4 OL5,OL6	CURRENT OVERLOAD .
1PH tr.	1 PHASE TR.(FOR CONTROL CIRCUIT & EM.CHUCK POWER SUPPLY).
3PH tr.	3 PHASE TR.(FOR SPINDLE SEAT RAPID UP&DOWN AND CROSS-FEED, LUBRICANT PUMP.PAPER FILTER MOTOR).

# 2040AHD SERIES PLC TYPE

## LAY OUT OF MAIN ELECTRICAL BOX

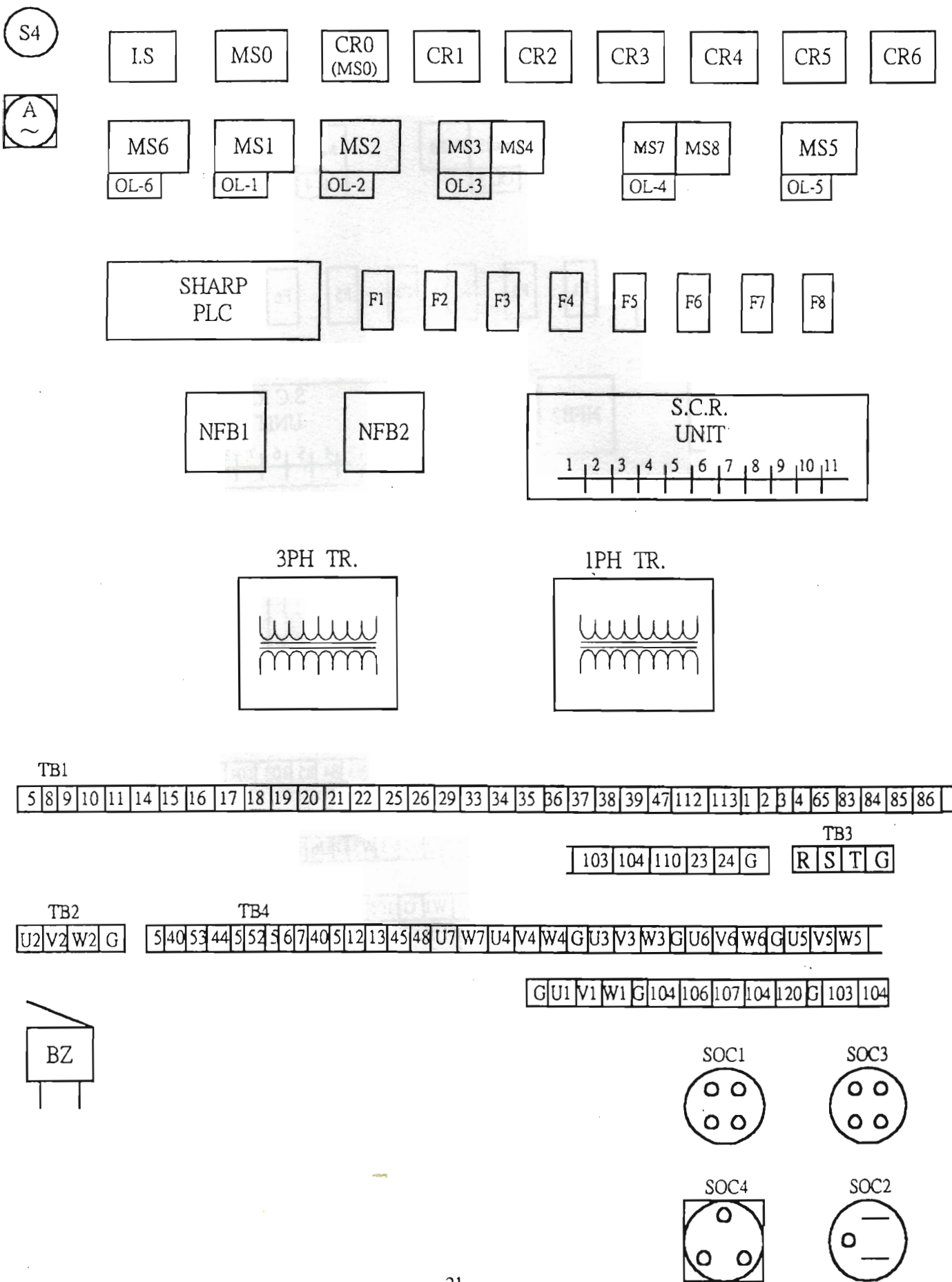

# 2040AH SERIES PLC TYPE

## LAY OUT OF MAIN ELECTRICAL BOX

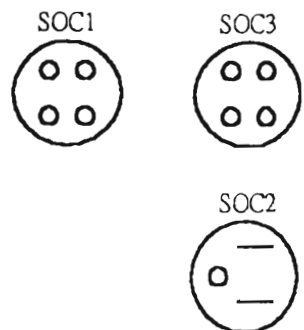
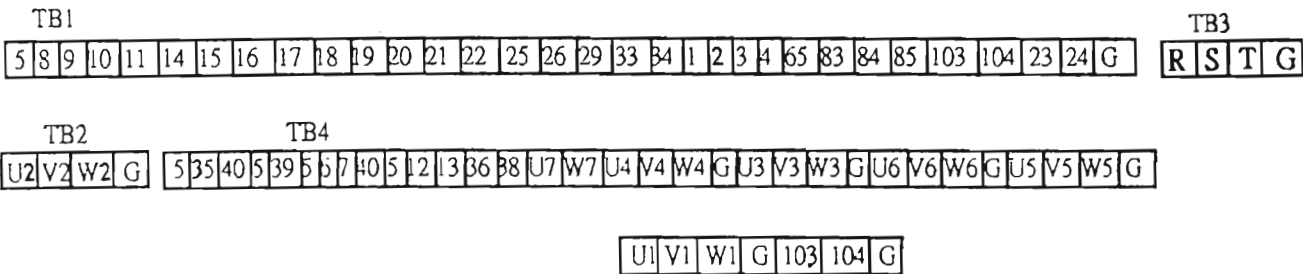
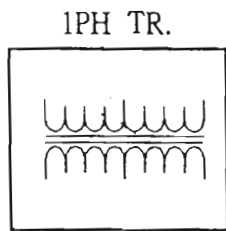
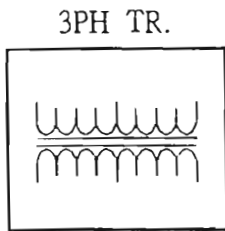
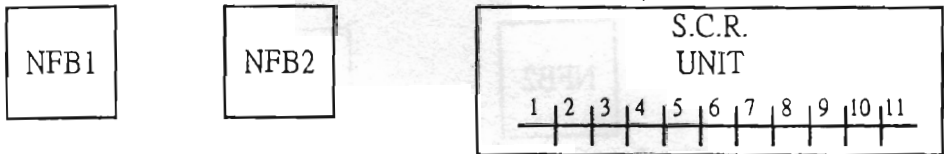
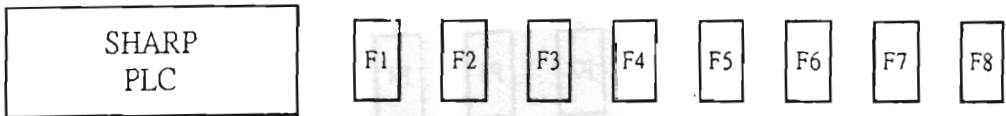
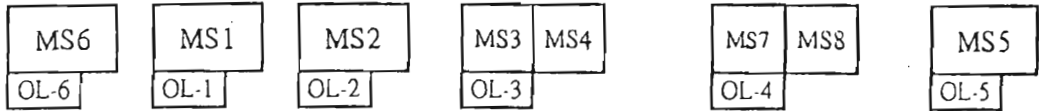

# 2040,2060AH(AHD) COLUMN ASS'Y

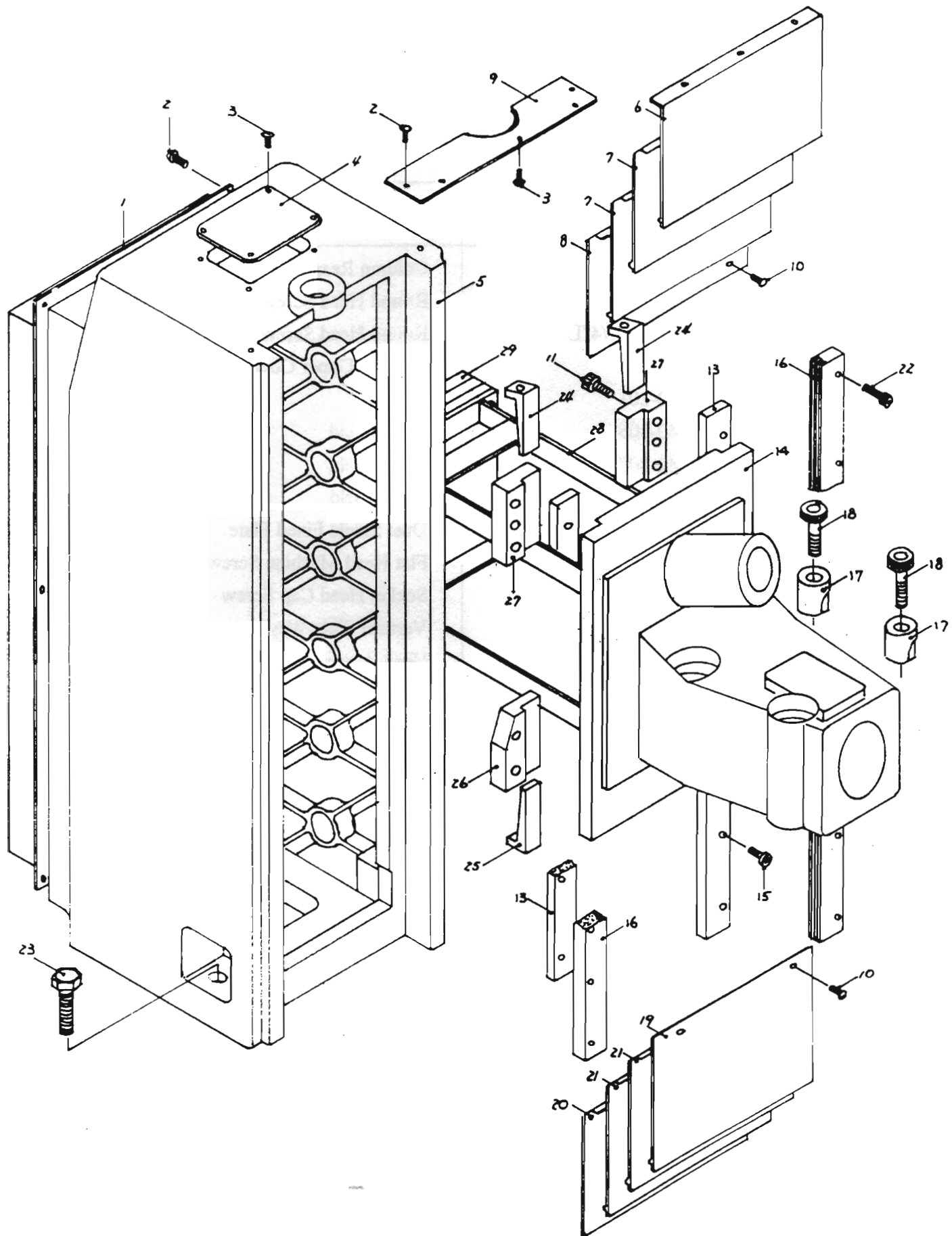



## UP COLUMN ASS'Y

(2040,2060SERIES)

Index No.	Parts No.	Parts Name	Qty
1.	2040-303A	Column Rear Cover	1
2.	W 1/4"*3/4"L	Round Head Screw	8
3.	W 3/16"*3/4"L	Round Head Screw	7
4.	2040-304	Column Upper Cover	1
5.	2040-201	Column	1
6.	2040-306	Dust Shield	1
7.	2040-307	Dust Shield	2
8.	2040-308	Dust Shield	1
9.	2040-305	Dust Shield Fixed Plate	1
10.	W 3/16"*3/4"L	Flat Head Machine Screw	4
11.	W 5/8"*3"L	Socket Head Cap Screw	8
13.	2040-301	Vertical Slide Way	2
14.	2040-202	Head A(Spindle Seat)	1
15.	W 3/8"*1 1/4"L	Socket Head Cap Screw	18
16.	2040-302	Shield Guide	2
17.	2040-312	Spindle Stopper	2
18.	W 3/4"*2 1/2"L	Socket Head Cap Screw	2
19.	2040-309	Dust Shield	1
20.	2040-311	Dust Shield	1
21.	2040-310	Dust Shield	2
22.	W 1/4"*1"L	Socket Head Cap Screw	12
23.	W 1"*2 1/2"L	Hexagonal Head Cap Screw	5
24.	2040-229	Tapper Plate	2
25.	2040-229-1	Tapper Plate	2
26.	2040-228	Fixed Plate Of Head A(Upper)	2
27.	2040-227	Fixed Plate Of Head A(Lower)	2
28.	2040-205	Frame Of Balance Weight	1
29.	2040-206	Balance Weight	3

# 2040,2060AH(AHD) CROSS-FEED ASS'Y

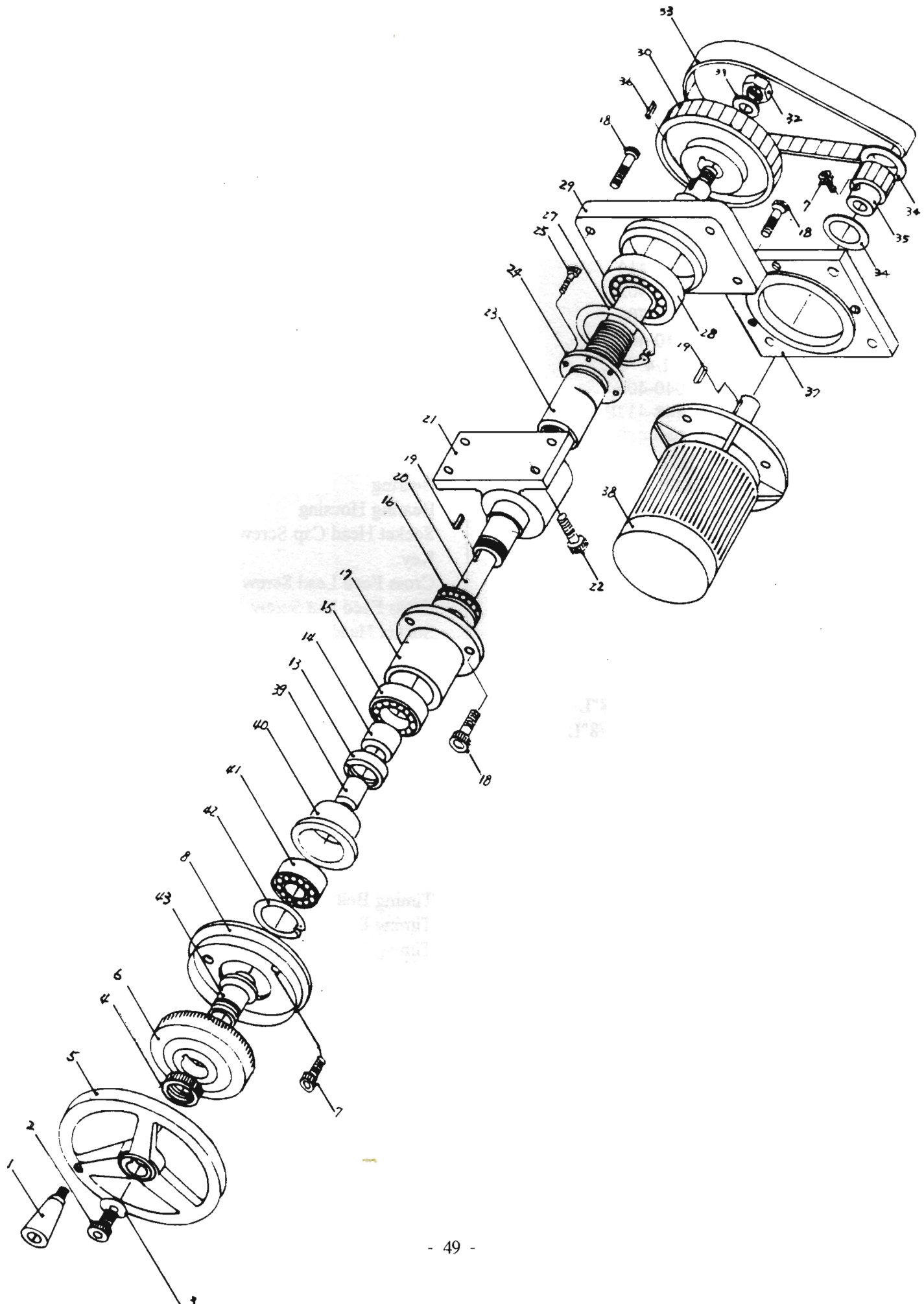

# CROSS FEED ASS'Y

(2040,2060SERIES)

Index No.	Parts No.	Parts Name	Qty
1.	1020-728	Head Grip	1
2.	W 1/4"*5/8"L	Socket Head Cap Screw	1
3.	2040-414	Washer	1
4.	2040-402	Nut	1
5.	1020-704	Hand Wheel with Clutch Gear	1
6.	2040-404	Graduation Dial	1
7.	W 1/4"*1/2"L	Socket Head Cap Screw	7
8.	2040-405	Dial Holder	1
13.	2448-432B	Lock Nut	1
14.	2040-409	Washer	1
15.	B5205	Bearing	1
16.	51205	Bearing	1
17.	2448-435A	Bearing Housing	1
18.	W 3/8"*3/4"L	Socket Head Cap Screw	1
19.	5*5*20L	Key	2
20.	2040-435	Cross Feed Lead Screw	1
21.	2040-430	Cross Feed Nut Screw	1
22.	W 1/2"*1 3/4"L	Socket Head Cap Screw	15
23.	2040-436	Lead Screw Base	2
24.	2040-434	Backlash Adjuster	1
25.	W 1/4"*5/8"L	Socket Head Cap Screw	1
26.	W 5/16"*5/8"L	Socket Head Cap Screw	4
27.	R-52	Snap Ring	1
28.	B1205Z	Bearing	1
29.	2448-443	Bearing Housing	1
30.	2040-411	Timing Belt Pulley	1
31.	W 1/2"	Washer	1
32.	W 1/2"	Hexagonal Nut	1
33.	P 3/8"*330H	Timing Belt	1
34.	2040-413	Timing Belt Pulley Flange	2
35.	2040-412	Timing Belt Pulley	1
36.	5*5*25L	Key	1
37.	2448-447	Cross Feed Motor Fixed Plate	1
38.	1/4 HP*6P	Cross Feed Motor	1
39.	2040-442	Washer	1
40.	2040-440	Bearing Seat	1
41.	B2203	Bearing	1
42.	R40	Snap	1
43.	2040-441	Set Spacer	1

# 2040,2060AH(AHD) LONG HAND-FEED ASS'Y

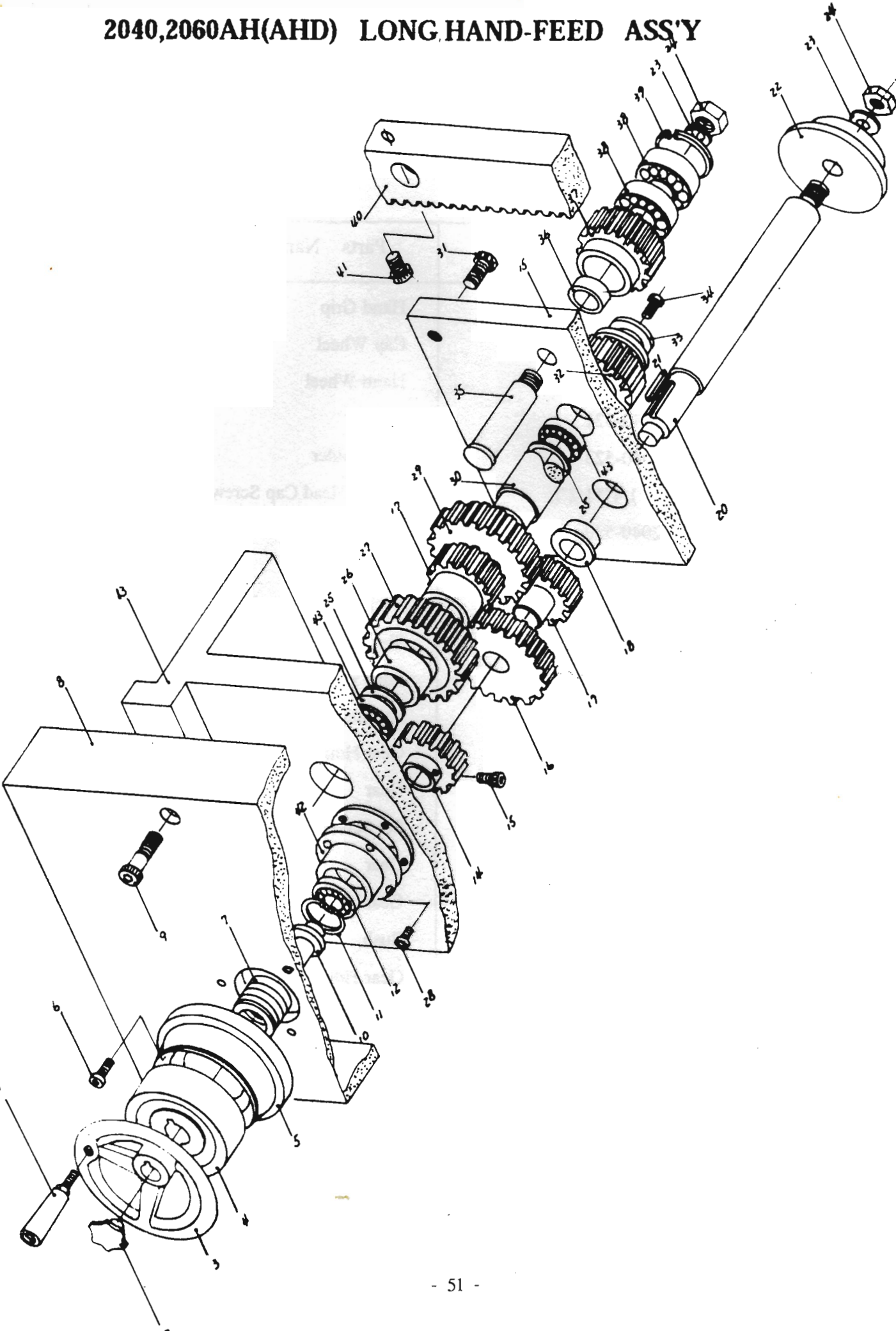

# LONGITUDINAL HANDFEED ASS'Y

(2040,2060 SERIES)

P. 1OF2

Index No.	Parts No.	Parts Name	Q'ty
1.	1020-728	Hand Grip	1
2.	1020-729	Cap Wheel	1
3.	1020-714	Hand Wheel	1
4.	2040-521	Dial	1
5.	2040-523	Dial Holder	1
6.	W 1/4"*1/2"L	Socket Head Cap Screw	3
7.	2040-520	Spring	1
8.	2040-117	Base Plate	1
9.	W 5/16"*6 1/2"L	Socket Head Cap Screw	6
10.	2040-519	Sleeve	1
11.	R-47	Snap Ring	1
12.	B6204Z	Bearing	1
13.	2040-503	Gear Housing	1
14.	2040-517	Gear	1
15.	W 1/4"*1/2"L	Set Screw	1
16.	2040-513	Gear	1
17.	2040-512	Gear	2
18.	2040-505	Bush	1
19.	2040-504	Gear Housing Plate	1
20.	2040-522	Shaft	1
21.	5*5*40L	Key	1
22.	2040-516	Spacer	1
23.	W 1/2"	Washer	2

# LONGITUDINAL HANDFEED ASS'Y

(2040,2060AHD)

P.2OF2

Index No.	Parts No.	Parts Name	Q'ty
24.	W 1/2"	Hexagonal Nut	2
25.	2040-506	Bush	2
26.	2040-514	Spacer	1
27.	2040-524	Gear	1
28.	W 5/16"*1 1/2"L	Socket Head Cap Screw	4
29.	2040-511	Gear	1
30.	2040-515	Shaft	1
31.	W 5/16"*1"L	Socket Head Cap Screw	4
32.	2040-510	Gear	1
33.	W 1/4"	Washer	1
34.	W 1/4"*1/2"L	Socket Head Cap Screw	1
35.	2040-509	Shaft	1
36.	2040-508	Washer	1
37.	2040-507	Gear	1
38.	B6203Z	Bearing	2
39.	R-40	Snap Ring	1
40.	2448-114	Rack	1
41.	W 3/8"*1"L	Socket Head Cap Screw	3
42.	2040-518	Bearing Housing	1
43.	B6003Z	Bearing	2

# 2040,2060AH DOWN-FEED ASS'Y

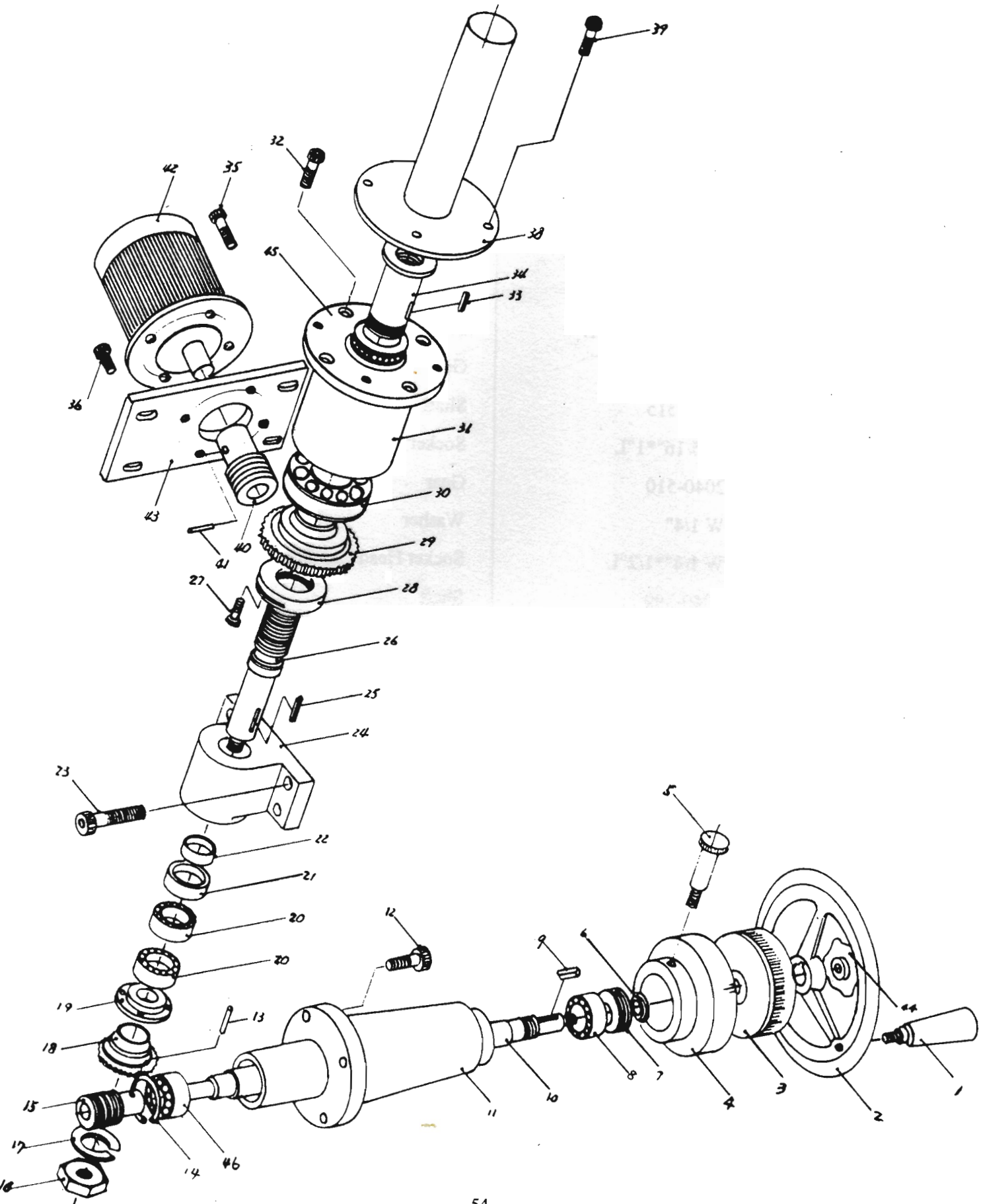

# DOWNFEED ASS'Y

(2040,2060AH SERIES)

P. 1OF2

Index No.	Parts No.	Parts Name	Q'ty
1.	1020-728	Hand Grip	1
2.	1020-714	Hand Wheel	1
3.	2040-226	Graduation Dial	1
4.	2040-225	Fixed Indicator	1
5.	1020-508	Adjusting Screw	1
6.	1020-410	Nut	2
7.	2040-219	Nut	1
8.	B5402Z	Bearing	1
9.	5*5*30L	Key	1
10.	2040-222	Shaft	1
11.	2040-221	Shaft Housing	1
12.	W 3/8"*1 1/2"L	Socket Head Cap Screw	4
13.	φ 5*30L	Pin	1
14.	R-47	Snap Ring	1
15.	2040-216	Worm	1
16.	W 3/4"	Hexagonal Nut	1
17.	W 3/4"	Spring Washer	1
18.	2040-213	Worm Gear	1
19.	2048-434	Bearing Housing Cover	1
20.	7205 P5	Bearing	2
21.	2040-212	Spacer	1
22.	2040-215	Spacer	1
23.	W 1/2"*1 3/4"L	Socket Head Cap Screw	4



# DOWNFEED ASS'Y

(2040,2060AH SERIES)

P.2OF2

Index No.	Parts No.	Parts Name	Q'ty
24.	2040-214	Bearing Housing	1
25.	7*7*25L	Key	1
26.	2040-210	Down-Feed Lead Screw	1
27.	W 1/4"*1/4"L	Socket Head Cap Screw	1
28.	2040-212-1	Nut	1
29.	2040-209	Worm	1
30.	B6210Z	Bearing	1
31.	2040-208	Bearing Housing	1
32.	W 3/8"*3/4"L	Socket Head Cap Screw	4
33.	5*7*25L	Key	1
34.	2040-211	Lead-Screw Nut	1
35.	W 5/16"*1"L	Socket Head Cap Screw	4
36.	W 5/16"*1"L	Socket Head Cap Screw	4
37.			
38.	2040-204A	Down-Feed Lead-Screw Housing	1
39.	W 5/16"*3/4"L	Socket Head Cap Screw	4
40.	2040-224	Worm	1
41.	φ 6*30L	Pin	1
42.	1/4HP*4P	Motor	1
43.	2040-223	Motor Plate	1
44.	1020-729	Cap Nut	1
45.	B51108	Bearing	1
46.	B2204Z	Bearing	1

# 2040,2060AHD DOWN-FEED ASS'Y

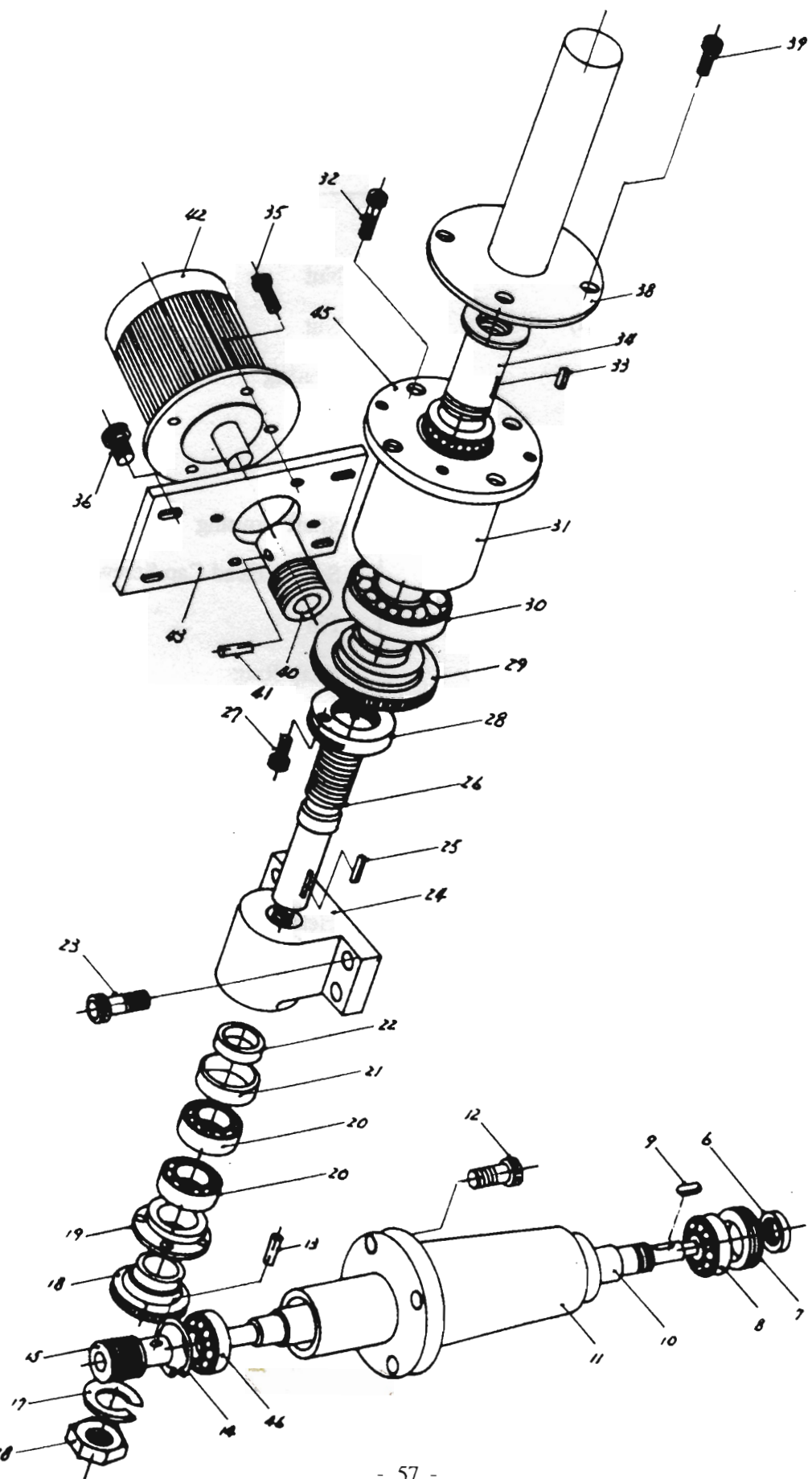

# DOWNFEED ASS'Y

(2040,2060AHD SERIES)

P. 1OF2

Index No.	Parts No.	Parts Name	Q'ty
6.	1020-410	Nut	2
7.	2040-219	Nut	1
8.	B5402Z	Bearing	1
9.	5*5*30L	Key	1
10.	2040-217	Shaft	1
11.	2040-218	Shaft Housing	1
12.	W 3/8"*1 1/2"L	Socket Head Cap Screw	4
13.	φ 5*30L	Pin	1
14.	R-47	Snap Ring	1
15.	2040-216	Worm	1
16.	W 3/4"	Hexagonal Nut	1
17.	W 3/4"	Spring Washer	1
18.	2040-213	Worm Gear	1
19.	2048-434	Bearing Housing Cover	1
20.	7205 P5	Bearing	2
21.	2040-212	Spacer	1
22.	2040-215	Spacer	1
23.	W 1/2"*1 3/4"L	Socket Head Cap Screw	4
24.	2040-214	Bearing Housing	1
25.	7*7*25L	Key	1

# DOWNFEED ASS'Y

(2040,2060AHD SERIES)

P.2OF2

Index No.	Parts No.	Parts Name	Q'ty
26.	2040-210	Down-Feed Lead Screw	1
27.	W 1/4"*1/4"L	Socket Head Cap Screw	1
28.	2040-212-1	Nut	1
29.	2040-209	Worm	1
30.	B6210Z	Bearing	1
31.	2040-208	Bearing Housing	1
32.	W 3/8"*3/4"L	Socket Head Cap Screw	4
33.	5*7*25L	Key	1
34.	2040-211	Lead-Screw Nut	1
35.	W 5/16"*1"L	Socket Head Cap Screw	4
36.	W 5/16"*1"L	Socket Head Cap Screw	4
38.	2040-204A	Down-Feed Lead-Screw Housing	1
39.	W 5/16"*3/4"L	Socket Head Cap Screw	4
40.	2040-224	Worm	1
41.	φ 6*30L	Pin	1
42.	1/4HP*4P	Motor	1
43.	2040-223	Motor Plate	1
45.	B51108	Bearing	1
46.	B2204Z	Bearing	1

# 2040,2060AHD AUTO DOWN-FEED ASS'Y

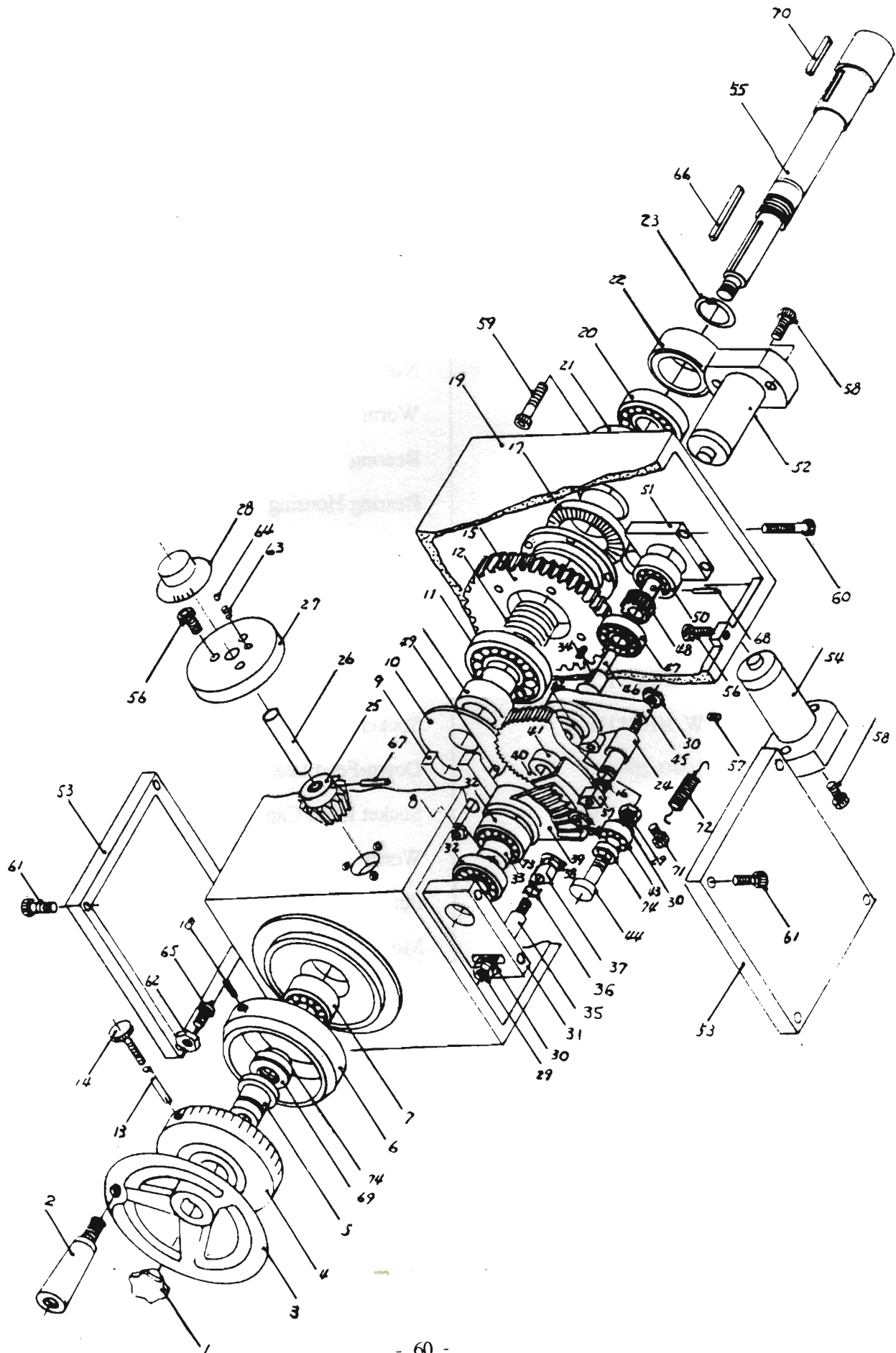

# AUTO-DOWNFEED UNIT ASS'Y

(2040,2060AHD SERIES)

P. 1OF2

Index No.	Parts No.	Parts Name	Q'ty
1.	1020-729	Cap Nut	1
2.	1020-728	Hand Grip	1
3.	1020-714	Hand Wheel	1
4.	2040-801	Graduation Dial	1
5.	1020-N804	Collar	1
6.	2040-803	Graduation Dial Holder	1
7.	B6204Z	Bearing	1
8.	1020-N842	Spacer	1
9.	1020-N810	Holder	1
10.	1020-N811	Holder	1
11.	B6006Z	Bearing	1
12.	1224-812	Spring	1
13.	φ 6*30L	Pin	1
14.	1020-N808	Fixed Screw	1
15.	2040-813	Gear	1
16.	1020-N828	Spring	1
17.	1020-N814	Clutch	1
18.	W 1/4"*3/8"L	Set Screw	1
19.	2040-802	Gear Box	1
20.	B6005Z	Bearing	1
21.	1020-N845	Connect Bracket	1
22.	1020-N843	Spacer	1
23.	R-35	Snap Ring	1
24.	1020-N826	Shaft	1
25.	1020-N830	Bevel Gear	1
26.	1020-N831	Pin	1
27.	1020-N832	Plate	1
28.	1020-N833	Pre-Set Dial	1
29.	W 3/4"	Hexagonal Nut	2
30.	W 3/4"	Spring Washer	2
31.	1020-N815	Bracket	1
32.	B6300Z	Bearing	3
33.	1020-N817	Spacer	1
34.	5*5*30L	Key	1
35.	1020-N815-1	Pin	1
36.	1020-N827	Spring	1
37.	1020-N825	Transmission Claw	1

# AUTO-DOWNFEED UNIT ASS'Y

(2040,2060AHD SERIES)

P.2OF2

Index No.	Parts No.	Parts Name	Q'ty
38.	E7	Snap Ring	2
39.	1020-N818	Bevel Gear (Half)	1
40.	1020-N820	Ratcher Gear	1
41.	1020-N821	Spacer	1
42.	B608ZZ	Spacer	1
43.	W 1/4"*1/4"L	Bearing	1
44.	1020-N823	Pin	1
45.	1020-N822	Transmission Arm	1
46.	1020-N816	Shaft	1
47.			
48.	2040-812	Gear	1
49.	W 1/4"*3"L	Socket Head Cap Screw	1
50.	B62012	Bearing	1
51.	1020-N829	Bracket	1
52.	1020-N838	Cylinder	1
53.	2040-809	Cover	2
54.	1224-881	Cylinder	1
55.	2040-807	Shaft	1
56.	W 3/16"*1/2"L	Socket Head Cap Screw	3
57.	W 3/16"*1/4"L	Set Screw	1
58.	W 3/16"*1"L	Socket Head Cap Screw	8
59.	W 1/4"*3/4"L	Socket Head Cap Screw	4
60.	W 1/4"*1 1/4"L	Socket Head Cap Screw	4
61.	W 1/4"*3/8"L	Socket Head Cap Screw	8
62.	W 1/4"	Hexagonal Nut	1
63.	W 1/4"	Spring	1
64.	φ 4	Steel Ball	1
65.	W 1/4"*5/8"L	Round Head Screw	1
66.	5*5*40L	Key	1
67.	φ 3*30L	Pin	1
68.	φ 30*10L	Pin	1
69.	1020-N805	Spacer	1
70.	5*5*35L	Key	1
71.	W 3/16"*3/8"L	Socket Head Cap Screw	1
72.	1020-N822-1	Spring	1
73.	R-35	Snap Ring	1
74.	1020-N806	Nut	1

# 2040,2060AHD SPINDLE ASS'Y

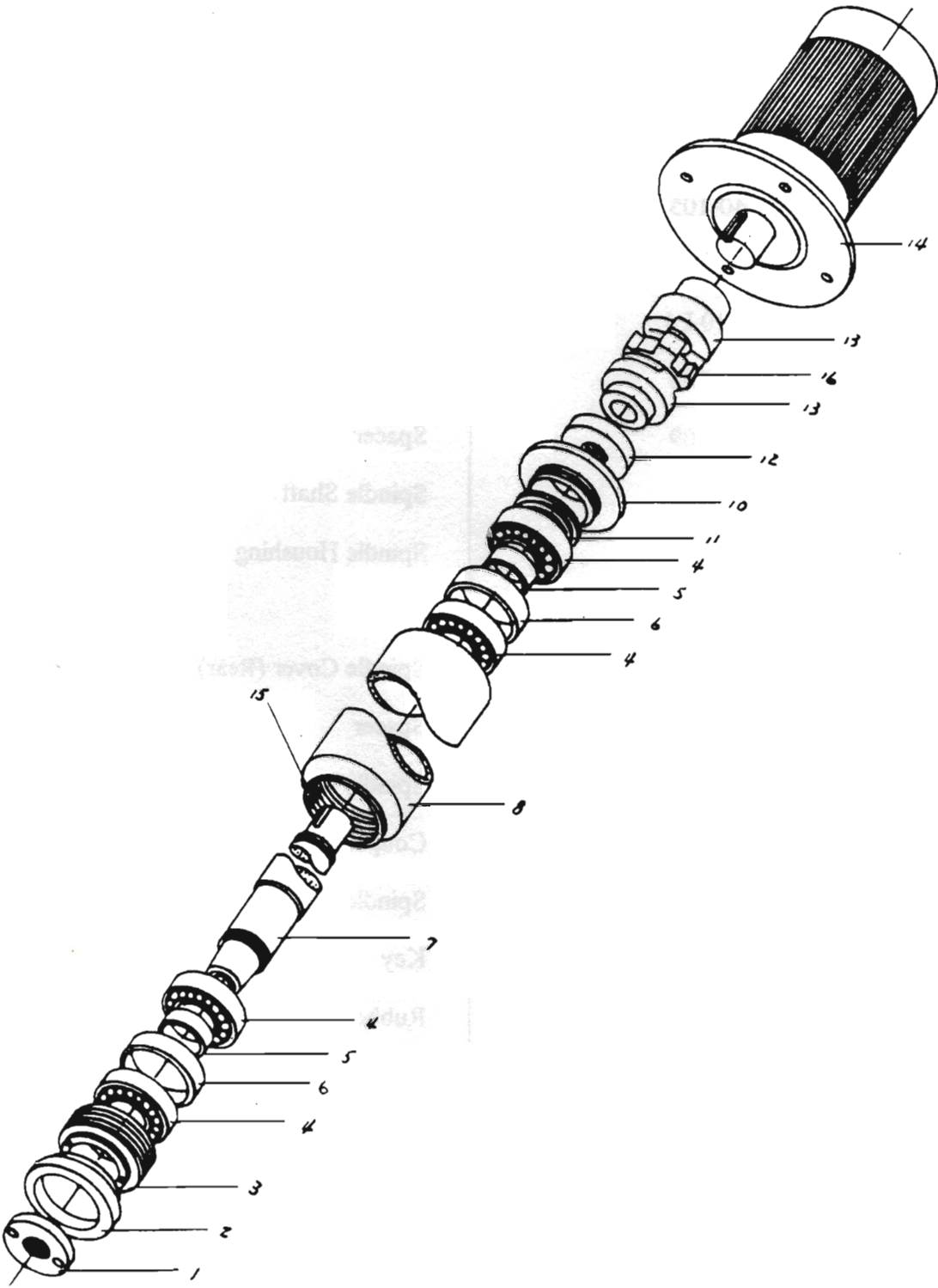



# SPINDLE SET ASS'Y

(2040,2060 SERIES)

Index No.	Parts No.	Parts Name	Q'ty
1.	2040-107	Spindle Cover (Fornt)	1
2.	2040-105	Spindle Cover (Front)	1
3.	2040-106	Spindle Nut	1
4.	B7210 P4	Bearing	4
5.	2040-108	Spacer	2
6.	2040-109	Spacer	2
7.	2040-104	Spindle Shaft	1
8.	2040-103	Spindle Houshing	1
9.			
10.	2040-112	Spindle Cover (Rear)	1
11.	2040-110	Spacer	1
12.	2040-111	Spindle Nut	1
13.	1632-111	Coupling	2
14.	10HP*4P	Spindle Motor	1
15.	10*8*35L	Key	1
16.	1632-113	Rubber Coupling	1

# 2040,2060AHD CYLINDER SET ASS'Y

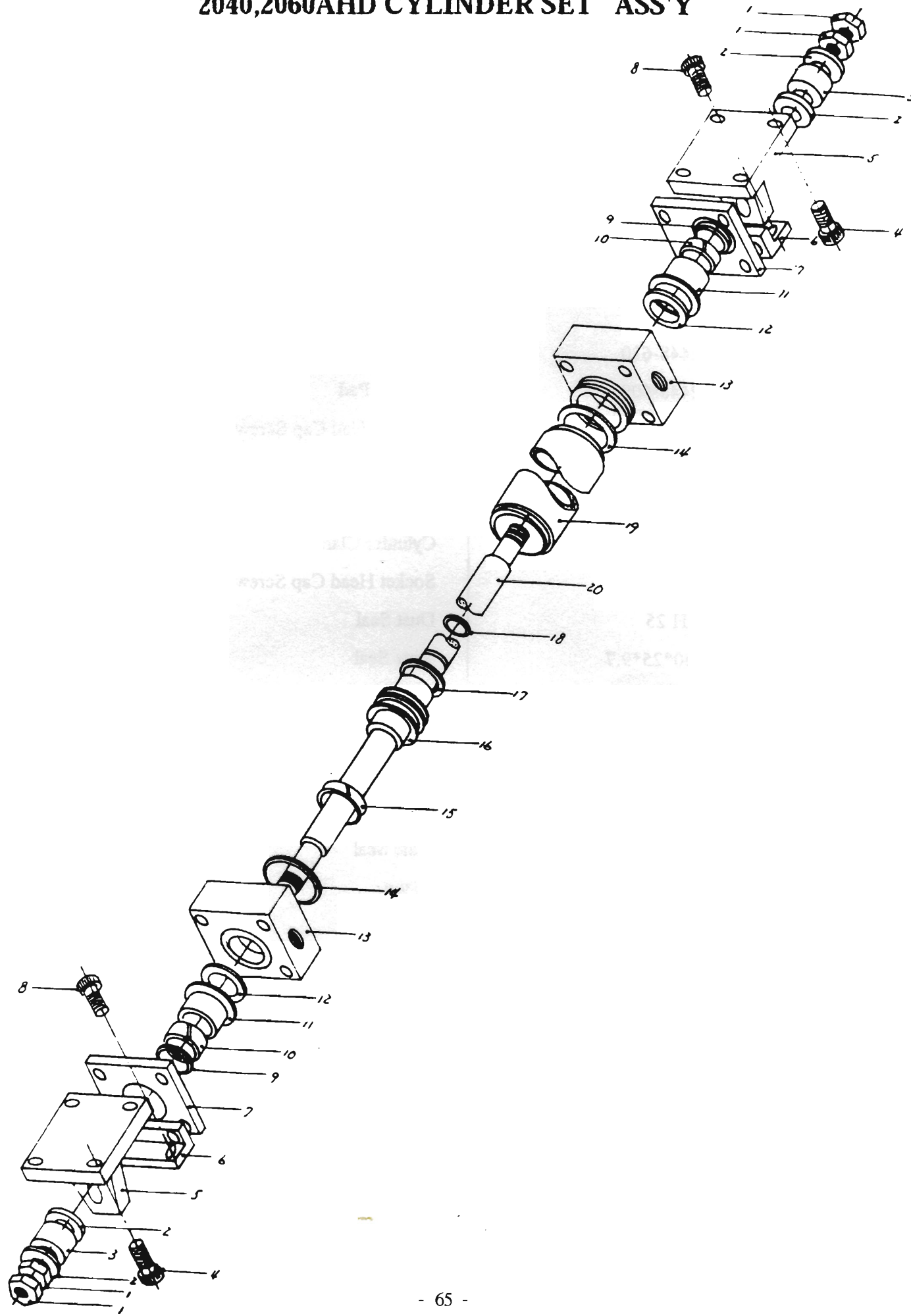

# CYLINDER SET ASS'Y

(2040,2060 SERIES)

Index No.	Parts No.	Parts Name	Q'ty
1.	W 3/4"	Hexagonal Nut	4
2.	2448-610	Washer	4
3.	2448-609	Rubber Pad	2
4.	W 1/2"*1 1/2"L	Socket Head Cap Screw	8
5.	2448-611	Cylinder Bracket	2
6.	2448-604	End Bracket	2
7.	2040-608	Cylinder Clamper	2
8.	W 1/2"*1"L	Socket Head Cap Screw	4
9.	LH 25	Dust Seal	2
10.	30*25*9.7	Slide Seal	2
11.	2040-606	Auxiliary	2
12.	USH 25	U Packing	2
13.	2040-602	End Cover	2
14.	G 40	O-Ring	2
15.	40*35*9.7	Slide Seal	1
16.	2040-605	Piston	1
17.	P 39	O-Ring	1
18.	P 21	O-Ring	1
19.	2040-601(for 2040 series)	Cylinder Pipe	1
	2060-601(for 2060 series)	Cylinder Pipe	1
20.	2040-603(for 2040 series)	Cylinder Rod	1
	2060-603(for 2060 series)	Cylinder Rod	1

# 2040, 2060AH(AHD) VALVE ASS'Y

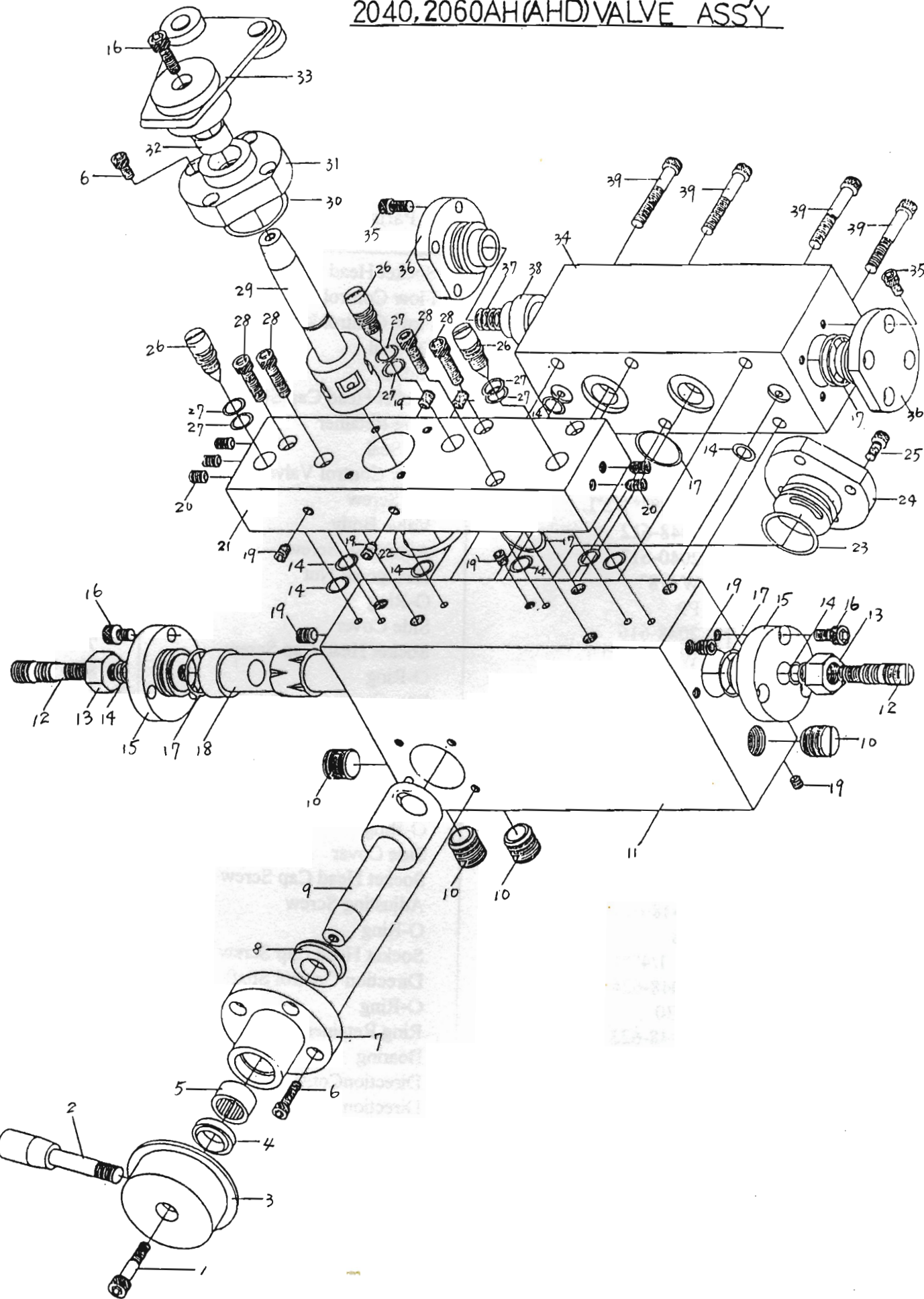

# VALVE ASS'Y

(2040,2060SERIES)

Index No.	Parts No.	Parts Name	Q'ty
1.	W 1/4"*5/8"L	Socket Head Cap Screw	1
2.	1020-627	Flow Control Lever	1
3.	1020-620	Flow Control Knob	1
4.	DH15	Oil Seal	1
5.	HK1516	Niddle	1
6.	W 3/16"*5/8"L	Socket Head Cap Screw	8
7.	2040-625 1/2"L	Ring Retainer	1
8.	RE-15	Oil Seal	1
9.	2040-625	Flow Control Valve	1
10.	W 5/8"*1/2"L	Set Screw	4
11.	2048-612	Valve Body	1
12.	2040-617	Adjusting Screw	2
13.	W 3/8"	Hexagonal Nut	2
14.	P9	O-Ring	10
15.	2048-616	Side Cover	2
16.	W 1/4"*1/2"L	Socket Head Cap Screw	7
17.	G22	O-Ring	8
18.	2048-615	Pilot Piston	1
19.	W 5/16"*3/8"L	Set Screw	8
20.	W 5/16"*1/2"L	Set Screw	5
21.	2048-613	Direction Valve Body	1
22.	G32	O-Ring	1
23.	G25	O-Ring	1
24.	2048-627	Side Cover	1
25.	W 3/16"*1/2"L	Socket Head Cap Screw	3
26.	2048-619	Adjusting Screw	3
27.	P8	O-Ring	6
28.	W 1/4"*1"L	Socket Head Cap Screw	5
29.	2048-624	Direction Control Shaft	1
30.	G30	O-Ring	1
31.	2048-623	Ring Retainer	1
32.	B1517	Bearing	1
33.	1020-616	DirectionControl Arm	1
34.	2048-614	Direction Valve Body	1
35.	W 3/16"*5/16"L	Socket Head Cap Screw	8
36.	2048-620	Side Cover	2
37.	2048-622	Spring	1
38.	2048-621	Direction Control Shaft	1
39.	W 1/4"*2 1/4"L	Socket Head Cap Screw	6

# 2040,2060AH HYDRAULIC PUMP UNIT ASS'Y

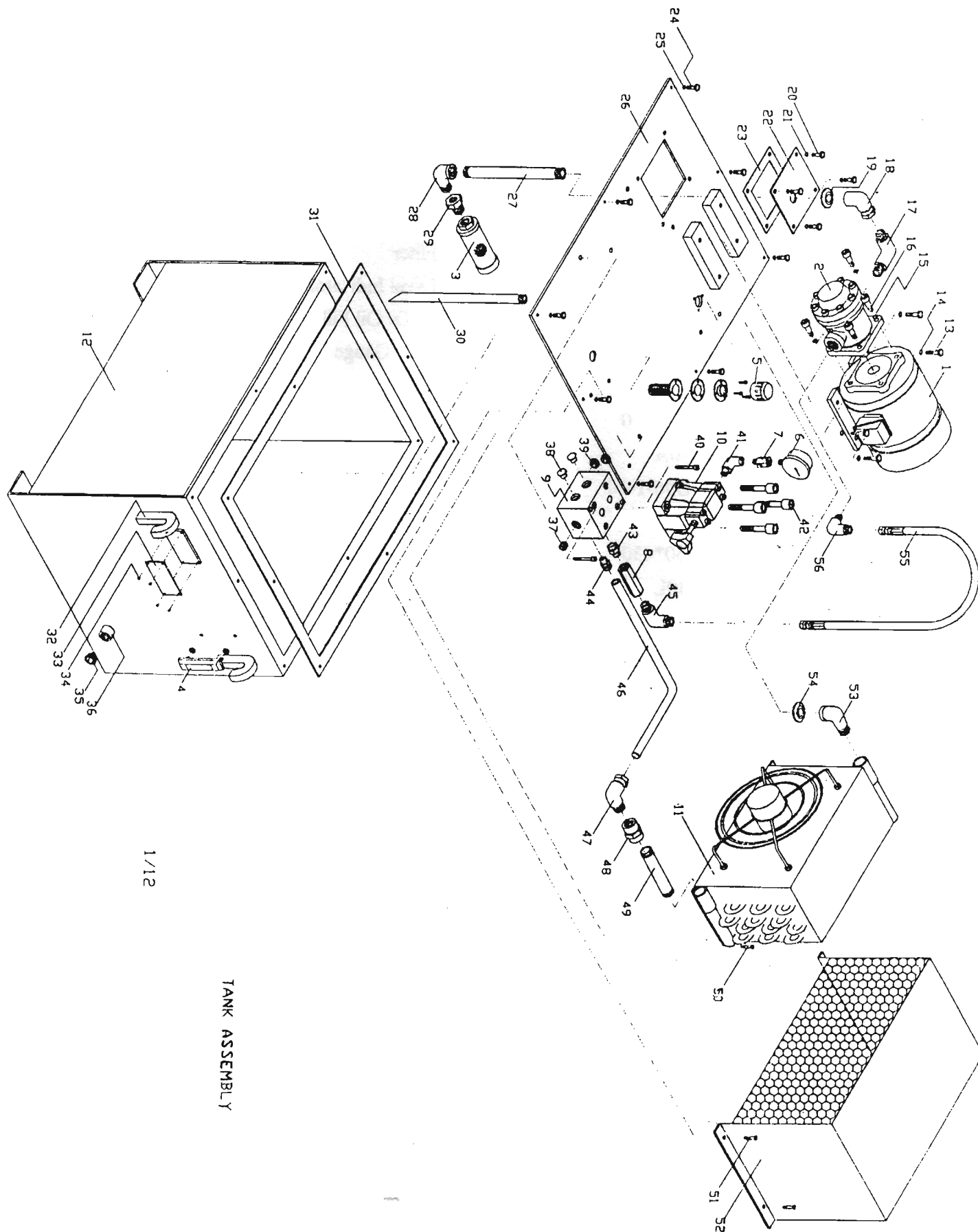

1/12

TANK ASSEMBLY

# HYDRAULIC PUMP UNIT ASS'Y

(2040,2060AH)

P. 1OF2

Index No.	Parts No.	Parts Name	Qty
1.	5HP*4P	Motor	1
2.	VPNCG-F26-2-30	Pump	1
3.	SS-1.25-100	Oil Filter	1
4.	KS-5"	Oil Level Indicator	1
5.	AB-1163	Cover Of Oil Fill Cover	1
6.	2 1/2"*70KG	Pressure Gauge	1
7.	1/4"PT	Gauge Cock	2
8.	CIT-06-05-10	Check Valve	2
9.	EM-370A	Manifold Board	1
10.	HRF-G06-1-10	Relief	1
11.	EM268	Oil Cooler	1
12.	910*650*450	Tank	1
13.	M10*30L	Hexagonal Head Screw	1
14.	SWM10	Spring Washer	1
15.	SWM10	Spring Washer	1
16.	M10*30L	Socket Head Cap Screw	2
17.	1"PT*1"PS	Connector ( 90° )	1
18.	1"PT(F)*1"PS(M)	Universal Connector ( 90° )	4
19.	ST-08	Dust Rubber	8
20.	M8*20L	Hexagonal Head Screw	4
21.	SWM8	Spring Washer	1
22.	CP-2060-1-1	Cover	1
23.	SS-2060-1-1	Asbestos Packing	2
24.	M8*20L	Hexagonal Head Screw	8
25.	SWM8	Spring Washer	1
26.	CT-2060-1-1	Cover Of Tank	1
27.	1"PT	Zine-Plate Pipe	1
28.	1"PT(F)*1"PT(M)	Connector ( 90° )	1
29.	1"PT(F)1 1/4"PT(M)	Bushing	1
30.	3/4"PT*580L(Slope)	Zine-Plate Pipe	1

# HYDRAULIC PUMP UNIT ASS'Y

(2040,2060AH)

P.2OF2

Index No.	Parts No.	Parts Name	Q'ty
31.	SS-2060-1-2	Asbestos Packing	1
32.	EM-375	Hang Bar	4
33.	NP-2060-1	Name Plate	1
34.	φ 2*6L	Rivet	4
35.	1/2"PT	PT Plug	1
36.	1/2"PT	Socket	1
37.	1/4"PT	PT Plug	1
38.	3/4"PT	Plastic Plug	2
39.	3/4"PT	PT Plug	2
40.	M6*65L	Socket Head Cap Screw	2
41.	1/4"PT(F)*1/4PT"(M)	Connector (90° )	1
42.	M16*50L	Socket Head Cap Screw	4
43.	3/4"PT*3/4"PT	Connector (90° )	1
44.	3/4"PT* φ 22mm	LE Connector	1
45.	3/4"PT*3/4"PS	Connector (90° )	1
46.	φ 22mm*2.0t	OST2 Pipe	1
47.	3/4"PT* φ 22mm	LE Connector ( 90° )	1
48.	3/4"PT*3/4"PT	Socket	1
49.	3/4PT"	Zinc-Plate Pipe	1
50.	M5*12L	Round Head Screw	4
51.	M5*12L	Round Head Screw	4
52.	CC-2060-1-1	Cover Of Cooler	1
53.	3/4"PT(F)*3/4"PT(M)	Connector (90° )	1
54.	ST-06	Dust Rubber	1
55.	3/4"PS*3/4"PS*620L	High Pressure	1
56.	3/4"PT*3/4"PS	Connector (90° )	1



# 2040,2060AHD HYDRAULIC PUMP UNIT ASS'Y

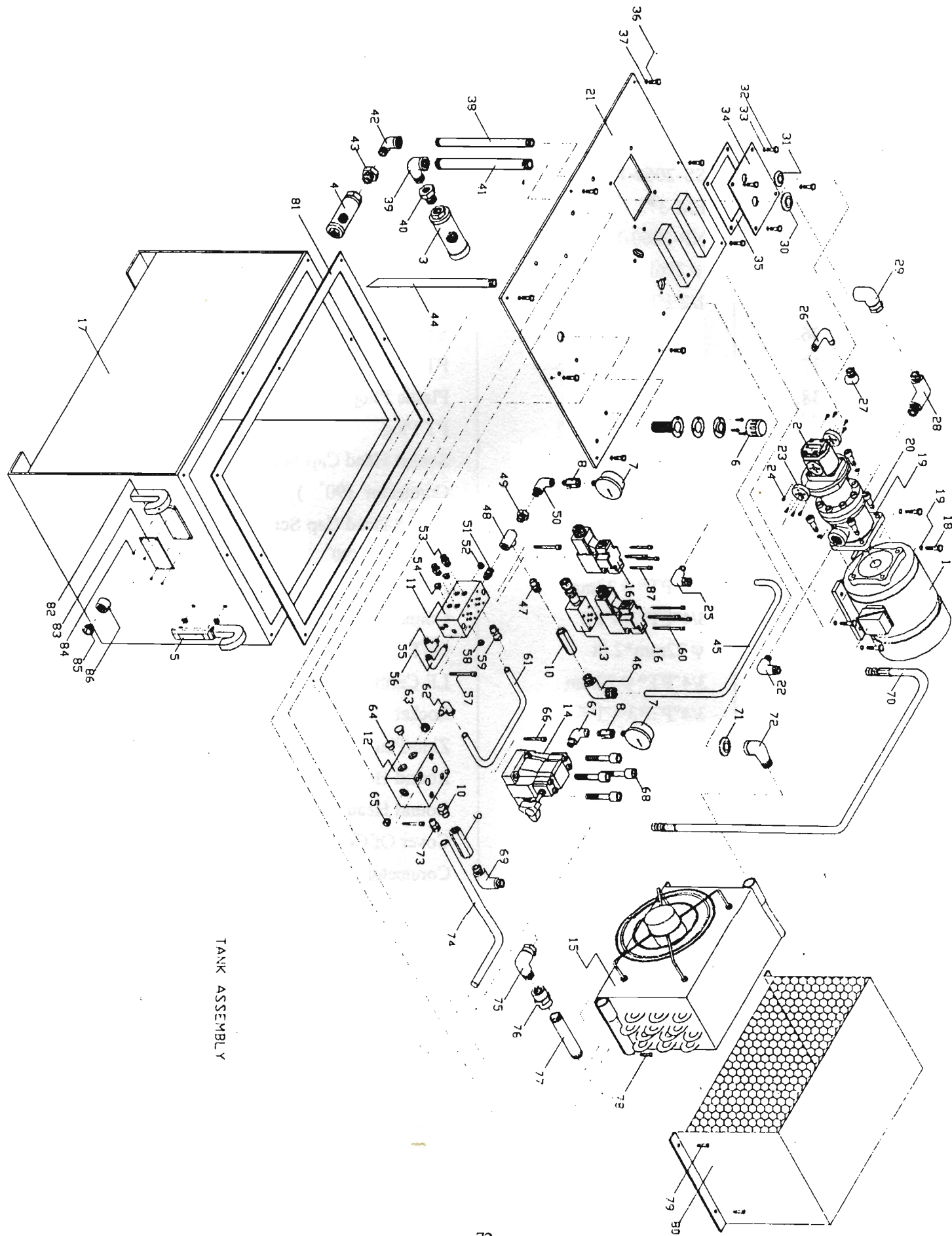

TANK ASSEMBLY

# HYDRAULIC PUMP UNIT ASS'Y

(2040,2060AHD)

P. 1OF3

Index No.	Parts No.	Parts Name	Qty
1.	5HP*4P	Motor	1
2.	VPNCG-F30/4.3-20	Pump	1
3.	SS-1.25-100	Oil Filter	1
4.	PS-06	Oil Filter	1
5.	KS-5"	Oil Level Indicator	1
6.	AB-1163	Cover Of Oil Fill Filter	1
7.	2 1/2"*70KG	Pressure Gauge	2
8.	1/4"	Gauge Cock	2
9.	CIT-06-05-10	Check Valve	1
10.	CIT-03-05-10	Check Valve	1
11.	M02 -2E	Manifold Board	1
12.	EM-370A	Manifold Board	1
13.	MRF-02P-0-K	Modular Relief Valve	1
14.	HRF-G06-1-10	Relief	1
15.	EM268	Oil Cooler	1
16.	SWH-G02-B2S-A110-10	Solenoid	2
17.	910*650*450	Oil Tank	1
18.	M10*30L	Hexagonal Head Screw	4
19.	SWM10	Spring Washer	8
20.	M10*30L	Socket Head Cap Screw	4
21.	CT-2060-2-1	Cover Of Tank	1
22.	3/4"PT*3/4"PS	Connector ( 90° )	1
23.	TEP4.3	Flange	2
24.	M5*20L	Socket Head Cap Screw	8
25.	3/8"PT* $\phi$ 12mm	LE Connector	1
26.	3/8"PT*1/2"PS	Connector ( 90° )	1
27.	1/2"PT(F)*1/2"PS(M)	Universal Connector ( 90° )	1
28.	1"PT*1"PS	Connector ( 90° )	1
29.	1"PT(F)*1"PS(M)	Universal Connector ( 90° )	1
30.	ST-08	Dust Rubber	1

# HYDRAULIC PUMP UNIT ASS'Y

(2040,2060AHD)

P.2OF3

Index No.	Parts No.	Parts Name	Qty
31.	ST-04	Dust Rubber	1
32.	M8*20L	Hexagonal Head Screw	4
33.	SWM8	Spring Washer	4
34.	CP-2060-2-1	Cover	1
35.	SS-2060-2-1	Asbestos Packing	1
36.	M8*20L	Hexagonal Head Screw	8
37.	SW-M8	Spring Washer	8
38.	1/2"PT	Zine-Plate Pipe	1
39.	1"PT(F)*1"PT(M)	Connector( 90° )	1
40.	1"PT(F)*1 1/4"PT(M)	Bushing	1
41.	1/2"PT	Zine-Plate Pipe	1
42.	1/2"PT(F)*1/2"PT(M)	Connector( 90° )	1
43.	1/2"PT(F)*3/4PT"(M)	Bushing	1
44.	3/4"PT*580L(Slope Cut)	Zine-Plate Pipe	1
45.	φ 15mm*2.0t	OST2 Pipe	1
46.	3/8"PT* φ 12mm	LE Connector ( 90° )	1
47.	3/8"PT*3/8"PT	Connector ( 90° )	1
48.	3/8"PT(M)	Connector ( 3 ways )	1
49.	1/4"PT*3/8"PT	Bushing	1
50.	1/4"PT(F)*1/4PT"(M)	Connector( 90° )	1
51.	3/8"PT*3/8"PT	Connector	1
52.	3/8"PT	Plastic Plug	1
53.	3/8"PT*1/4PS"	Connector	2
54.	3/8"PT	PT Plug	2
55.	3/8"PT*1/4PS"	Connector ( 90° )	1
56.	3/8"PT*1/4PS"(L)	Connector( 90° )	1
57.	M8*60L	Socket	2
58.	3/8"PT	PT Plug	1
59.	3/8"PT* φ 12mm	LE Connector ( 90° )	1
60.	M5*85L	Socket Head Cap Screw	4

# HYDRAULIC PUMP UNIT ASS'Y

(2040,2060AHD)

P.3OF3

Index No.	Parts No.	Parts Name	Q'ty
61.	$\varphi$ 12mm*2.0t	OST2 Pipe	1
62.	3/8"PT* $\varphi$ 12mm	LE Connector( 90° )	1
63.	3/4"PT	PT	1
64.	3/4"PT	Plastic Plug	2
65.	3/4"PT	PT Plug	1
66.	M6*65L	Socket Head Cap Screw	2
67.	1/4"PT(F)*1/4"PT(M)	Connector (90° )	1
68.	M16*50L	Socket Head Cap Screw	4
69.	3/4"PT*3/4"PS	Connector (90° )	1
70.	3/4"PS*3/4"PS*620L	High Pressure Tube	1
71.	ST-06	Dust Rubber	1
72.	3/4"PT(F)*3/4"PT(M)	Connector (90° )	1
73.	3/4"PT* $\varphi$ 22	LE Connector (90° )	1
74.	$\varphi$ 12mm*2.0t	OST2 Pipe	1
75.	3/4"PT* $\varphi$ 22	LE Connector ( 90° )	1
76.	3/4"PT*3/4"PT	Socket Head Cap Screw	1
77.	3/4"PT	Zine-Plate Pipe	1
78.	M5*12L	Screw	4
79.	M5*12L	Screw	4
80.	CC-2060-2-1	Cover of Cooler	1
81.	SS-2060-2-2	Asbestos Packing	1
82.	EM-375	Hang Bar	4
83.	NP-2060-2-1	Name Plate	1
84.	$\varphi$ 2*6L	Rivet	4
85.	1/2"PT	PT Plug	1
86.	1/2"PT	Socket	1
87.	M5*45L	Socket Head Cap Screw	4

# 2040,2060 SERIES PARALLEL DRESSER ASS'Y

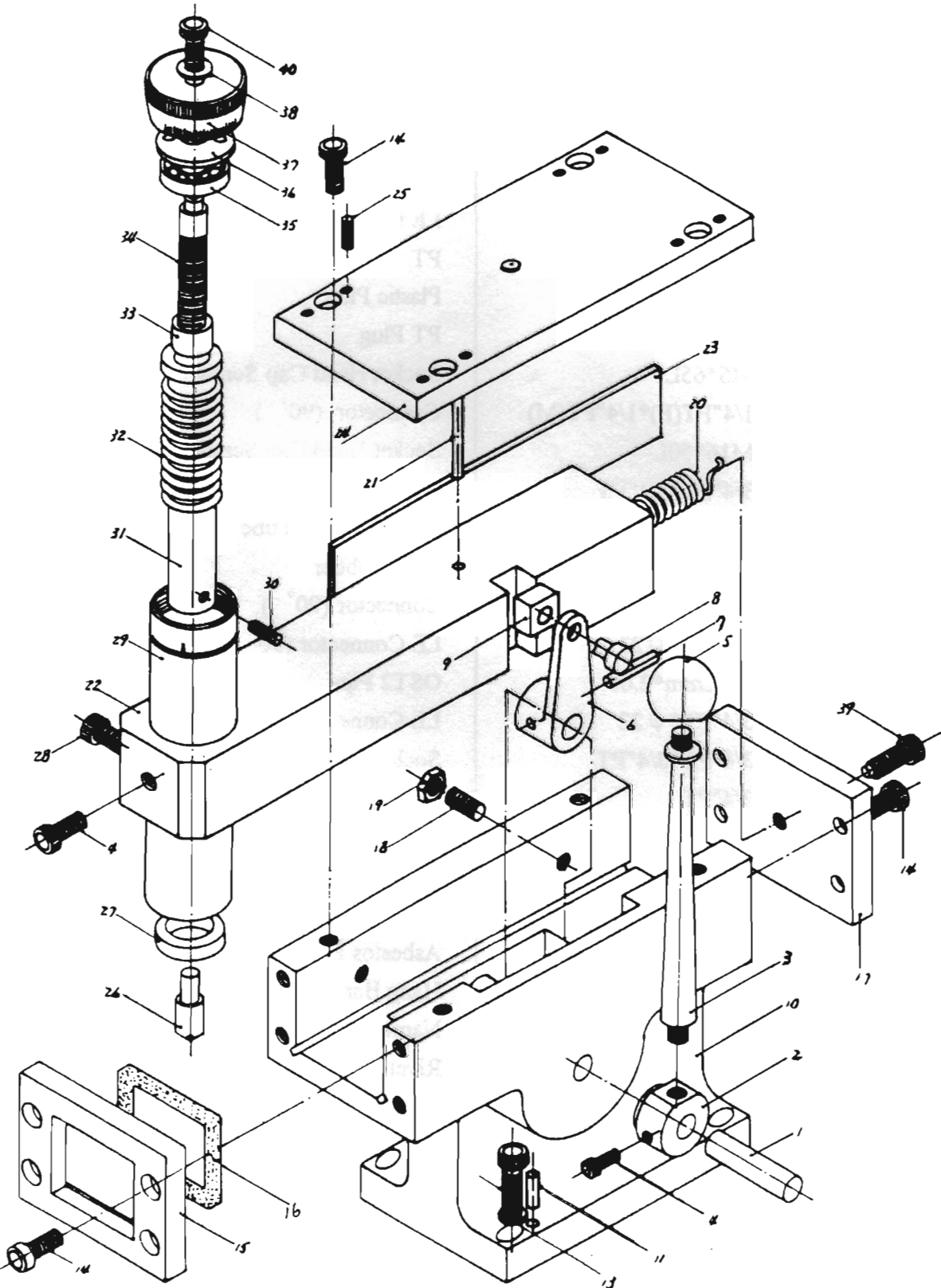

# PARALLEL DRESSER ASS'Y

(2040,2060SERIES)

Index No.	Parts No.	Parts Name	Qty
1.	2040-737	Shaft	1
2.	1020-738	Transmission Cap	1
3.	2040-739	Transmission Lever	1
4.	W 5/16"*1/2"L	Socket Head Cap Screw	2
5.	1020-740	Cap	1
6.	1020-741	Transmission Arm	1
7.	W 1/4"*3/8"L	Socket Head Cap Screw	1
8.	1020-742	Shaft	1
9.	1020-743	Slipper	1
10.	2040-730	Dresser Body	1
11.	W 1/4"*5/8"L	Set Screw	4
12.	W 5/16"*1"L	Socket Head Cap Screw	4
13.	W 5/16"	Spring Washer	4
14.	W 1/4"*1/2"L	Socket Head Cap Screw	13
15.	2040-733	Front Cover	1
16.	2040-735	Oil Immersed Pad	1
17.	2040-734	Rear Cover	1
18.	W 1/4"*1"L	Set Screw	3
19.	W 1/4"	Hexagonal Nut	3
20.	2040-744	Spring	1
21.	W 1/4"*1 1/2"L	Set Screw	1
22.	2040-731	Moving Body	1
23.	2040-736	Adjusting Plate	1
24.	2040-732	Top Cover	1
25.	W 3/16"*1/2"L	Set Screw	4
26.	2040-745	Diamond Cutter	1
27.	RE-20	U-Packing	1
28.	W 1/4"*1/2"L	Socket Head Cap Screw	1
29.	1020-746	Out-Holder	1
30.	W 3/16"*3/8"L	Socket Head Cap Screw	1
31.	1020-748	Moving Muff	1
32.	1020-749	Spring	1
33.	1020-750	Nut	1
34.	1020-751	Transmission Rod	1
35.	B6200Z	Bearing	1
35.	1020-752	Nut	1
37.	1020-753	Graduation Dial	1
38.	W 1/4"	Spring Washer	1
39.	W 1/4"*1/2"L	Socket Head Cap Screw	1