



Springwood Industrial, Inc.
2320 E Valencia Dr
Fullerton , CA 92831
Tel: 714-871-5558 Fax: 714-871-5554
<http://www.aceronline.net>

info@aceronline.net

Klim Industrial, Inc.
244 N. Randolphville Road
Piscataway, NJ 08854
Tel: 732-752-9100 Fax: 732-752-9101
<http://www.aceronline.net>

acer_klim@yahoo.com

PROCEDURE TO SWAP UPPER & LOWER LEAD SCREW

1. Take a piece of wood to support the spindle head on the table.
2. Remove the Connect Flange assembly.

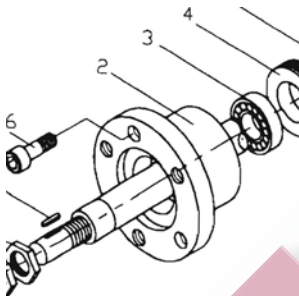

3. Loosen the Clutch B and move the shaft (whole assembly) to the front.

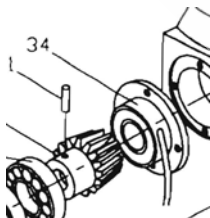

4. Take off the Rapid Up & Down Motor.

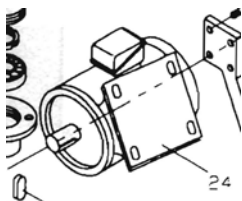

5. Take off the Upper & Lower Lead Screw Mounting Assembly.

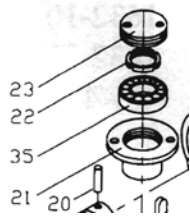

6. Loosen up the Gear Seat.

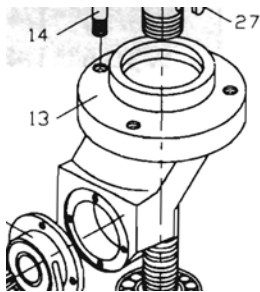

7. Separate the top assembly and bottom assembly.

8. Take off lead screw.

9. Swap new lead screw into same position.

Upper & Lower Transmission Ass'y

FOR AGS 1020/1224AHD

